

# Do it yourself ESTIMATE WorkSheet

**Easily create an ESTIMATE yourself.** The steps are simple. All you need are the total Width and Height measurements in inches from all your windows added together and then multiplied by one of our Special Quantity Discounts. And, if you have any arched windows you will add an additional \$20 per arched window. Because this is for the purpose of an estimate ONLY, your measurements do not need to be accurate, just close (rough). Getting your measurements is easy; comfortably do so from inside your home, there is no need to go outside. Hint : Many of your windows will be the same.

## Step 1 Measure the width of your windows in inches

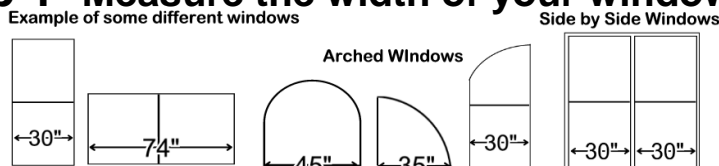

Please be sure to watch our "Do it yourself Estimate Worksheet" Video on our website to show you how to do this quickly and easily.

[www.JoshHobbs.com](http://www.JoshHobbs.com)

## Step 2 Measure the height of your windows in inches

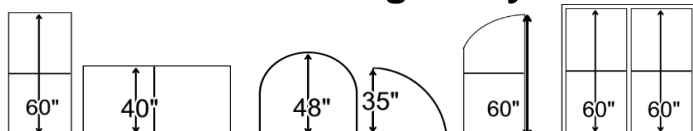

## Step 3 Calculate your measurements here

	Width	Height	
Window #1	_____	_____	
Window #2	_____	_____	
Window #3	_____	_____	
Window #4	_____	_____	
Window #5	_____	_____	
Window #6	_____	_____	
Window #7	_____	_____	
Window #8	_____	_____	
Window #9	_____	_____	
Window #10	_____	_____	
Window #11	_____	_____	
Window #12	_____	_____	
Window #13	_____	_____	
Window #14	_____	_____	
Window #15	_____	_____	
Window #16	_____	_____	
Window #17	_____	_____	
Add each column	_____ + _____ =	_____	Total Inches
	Width total	Height total	
	Multiply the Total Inches for all your Windows by	x	\$0.82 or _____
			= _____
Arch Qty _____	x \$20ea = _____		+ _____
This Estimated cost is for EVERYTHING: Measurements, Assembly, Installation and Sales Tax = _____			

**80% vs 90% Fabric :**  
Percentage of shading (the fabric's density). Please see our Questions & Answers Page on our website for a detailed explanation of the 80% vs 90% Fabric.

The below Pricing is for our 80% solar screen fabric. The upgrade cost to our 90% fabric is only **\$7 p/ Window**.

**Special Discounts**

As a Special Quantity Discount, if your Total Inches are between these values, then use these discounted multipliers, and save.

(614" - 1350") **\$0.70 15%OFF**

(1351" - 2199") **\$0.66 20%OFF**

(2200"+) **\$0.62 25%OFF**

\*\* Minimum Order \*\*  
Any size order under 613" or less is a flat installed rate of \$430.  
Plus Arch fees, 90% upgrades, grid patterns.

## Step 4 Start your order online at [www.JoshHobbs.com](http://www.JoshHobbs.com)

We make this very easy, all you have to do is click on the Buy Now button located at the bottom of our web page which processes a \$50 non-refundable deposit (to be applied against your order). Once we receive your deposit, we will swing by your house to measure your windows to get our build measurements (no one needs to be home for this). Once we get our build measurements, we will email you an order to approve with an installation date (no one needs to be home for the installation). Once we receive your approval, we will proceed with the assembly of your solar screen order. We are super fast, your new screens can be installed within two weeks. We made ordering Solar Screens Easy !

**Questions :** Josh Hobbs 512-351-5762 [Josh@JoshHobbs.com](mailto:Josh@JoshHobbs.com) Paula Hobbs 512-743-3682 [Paula@JoshHobbs.com](mailto:Paula@JoshHobbs.com)